

**PRODUCT-** REAR TAILGATE LED LIGHT

**VEHICLE-** 300 SERIES LANDCRUISER 2021+

**PART NUMBER-** JBA-LB804W/D, JBA-LB804WKIT1, JBA-LB804WKIT2, JBA-LB804DKIT1

**ESTIMATED FIT TIME**

- FITMENT OF LED LIGHT 45-60 MINS
- ELECTRICAL WIRING AND FITMENT OF SWITCHES 60-120MINS

**IMPORTANT NOTES**

- READ INSTRUCTIONS CAREFULLY PRIOR TO FITMENT
- SET ALL REMOVED PARTS ASIDE ON A SOFT CLEAN SURFANCE FOR RE-INSTALLATION
- ENSURE THAT ALL TRIM CLIPS ARE REMOVED FROM THE VEHICLE WHEN PULLING PANELS OUT AND RE-INSERTED BACK INTO THE PANELS BEFORE RE-INSTALLATION (SEE STEPS 1.7-1.8)

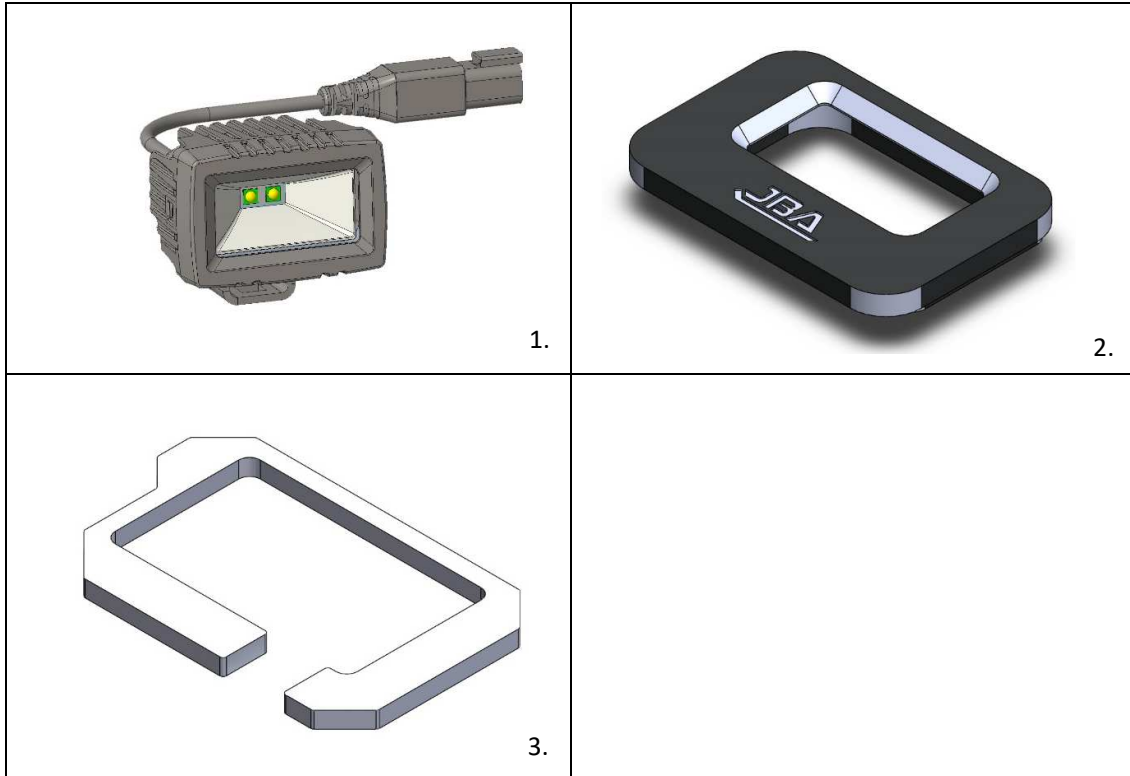

**KIT CONTENTS**

ITEM	DESCRIPTION	PART NO.	QTY
1	JBA 300 SERIES REAR TAILGATE LIGHT	10-LB804W/D	1
2	JBA 300 SERIES REAR TAILGATE LIGHT FASCIA	10-LB804A	1
3	JBA 300 SERIES REAR TAILGATE LIGHT REAR	10-LB804B	1

## 1. PREPARING THE VEHICLE



**STEP 1.1** REMOVE 2 X REAR HANDLE INSERTS PULLING DOWN FROM THE TOP CENTRE AND LEVERING FORWARD. FOR AUTO TAILGATE MODELS, UNCLIP THE POWER PLUGS ON DRIVERS SIDE.



**STEP 1.2** USING A PLASTIC TRIM TOOL, LEVER THE CENTRE LATCH COVER AND REMOVE.



**STEP 1.3** SEPARATE THE MID SECTION FROM THE REAR SECTION AS SHOWN KEEPING NOTE OF HOW THE TWO SECTIONS INTERLOCK FOR REINSTALL LATER.



**STEP 1.4** COMPLETEY UNCLIP THE MID AND REAR SECTIONS AS SHOWN. YOU CAN EITHER LEAVE THIS SECTION HANGING DOWN OR DISCONNECT THE BRAKE LIGHT AND FULLY REMOVE WHICH WILL MAKE WIRING EASIER LATER.



**STEP 1.5** START PULLING THE REAR SECTION DOWN FROM THE REAR HANDLE INSERT SECTION (STEP 1.1) TO ENABLE A GRIP ON THE TRIM FOR NEXT STEP.



**STEP 1.6** START FROM THE CORNER AND BEGIN PULLING DOWN POPPING THE TRIM CLIPS. THESE WILL BE FIRM BUT WILL POP. WORK YOUR WAY ACROSS THE REAR, FULLY REMOVE PANEL AND LAY ON A SOFT CLEAN SURFACE.



**STEP 1.7** AT THIS STAGE, QUICKLY CHECK IF ANY TRIM CLIPS HAVE REMAINED IN THE VEHICLE AND REMOVE WITH TRIM CLIP REMOVER.



**STEP 1.8** RE-INSERT CLIPS INTO THE PLASTIC TRIM PANEL LOCATION. THEY WILL NORMALLY SLIDE IN AND POP INTO POSITION. THIS STEP WILL ENSURE AN EASIER RE-INSTALLATION OF THE PANELS LATER.



**STEP 1.9** ON THE REAR PANEL, REMOVE THE PLASTIC COVER AND MARK THE INFILL SECTION FOR CUTTING AS SHOWN.



**STEP 1.10** CAREFULLY TRIM THE MARKED OUT SECTIONS WITH A STANLEY KNIFE AS SHOWN. TAKE CARE NOT TO CUT OR SCRATCH THE TOP SURFACE WHILE CUTTING.

## 1.1 ADDITIONAL STEPS ONLY REQUIRED FOR AUTO TAILGATE MODELS



**STEP 1.1.1** REMOVE THE WHITE PLASTIC COVER ON THE AUTO LOCKING LOCK AS SHOWN.



**STEP 1.1.2** THE SECTIONS OUTLINED IN WHITE NEED TO BE REMOVED, NOTE AND MARK THE AREAS SHOWN.



**STEP 1.1.3** TRIM BACK THE RAISED SECTIONS MARKED IN PREVIOUS STEP SO THEY ARE COMPLETELY FLAT AS SHOWN.

## 1.2 ADDITIONAL STEPS ONLY REQUIRED IF FITTING LB804WKIT1 WHITE LED 12MM INTEGRATED SWITCH



**STEP 1.2.1** NOTCH OUT THE BOTTOM LIP OF THE INSERT SECTION 30MM AS SHOWN



**STEP 1.2.2** PLACE THE JBA FASCIA ON A SOFT SURFACE SUCH AS SOME CLEAN CARDBOARD. USING A 12MM DRILL, BEGIN DRILLING SLOWLY UNTIL A SMALL HOLE BEGINS ON THE FRONT SIDE.



**STEP 1.2.3** TURN THE FASCIA OVER AND COMPLETE DRILLING HOLE ALL THE WAY THROUGH. TAKE YOUR TIME, DRILL SLOWLY AND STOP FREQUENTLY TO ENSURE PART DOESN'T SPIN WHILE DRILLING.



**STEP 1.2.4** INSERT SWITCH IN TO FASCIA AND TIGHTEN NUT FROM REAR USING 14MM SPANNER.

## 2. INSTALLING THE LIGHT

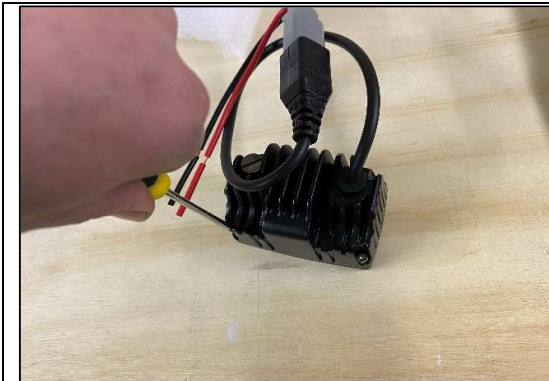

**STEP 2.1** REMOVE 4 X 2.5MM ALLEN KEY SCREWS FROM THE REAR OF THE LIGHT.



**STEP 2.2** SEPERATE THE FRONT FASCIA AND DISCARD (KEEP THE SCREWS).



**STEP 2.3** PRESS THE JBA FASCIA JBA-LB804A INTO THE REAR TAILGATE SECTION AS SHOWN. NOTE THE ORIENTATION, ENSURE THE CUT OUT FOR THE LIGHT IS FACING TOWARDS THE TOP AS SHOWN.



**STEP 2.4** PLACE REAR MOUNTING JBA-LB804B PLATE OVER FASCIA AS SHOWN.



**STEP 2.5** INSERT LIGHT INTO FASCIA AS SHOWN ENSURING THE MACHINED FACE OF THE LED IS IN THE ORIENTATION SHOWN (TOWARDS THE BOTTOM OF THE DOOR).



**STEP 2.6** RE INSTALL 4 X 2.5MM SCREWS REMOVED IN STEP 2.1 AND ENSURE LIGHT IS SITTING FLAT AND TIGHT.

### 3. WIRING THE LIGHT

- A NEW POWER WIRE WILL BE REQUIRED TO BE RUN FROM THE VEHICLE INTO THE TAILGATE AS THERE IS NO WIRING IN THE TAILGATE THAT CAN BE USED TO POWER THE 5A LED. 4MM WIRE IS RECOMMENDED.
- IF USING THE OPTIONAL JBA 2 WAY SWITCH (REFER TO STEP 4 BELOW), ONLY ONE POWER WIRE WILL BE REQUIRED TO BE RUN INTO THE TAILGATE. IF SWITCHING IN THE VEHICLE, TWO SEPARATE SWITCHES AND WIRES WILL BE REQUIRED. IF WIRING USING NON SUPPLIED SWITCHES, ENSURE THE SWITCHES ARE RATED TO A MINIMUM 5A. IF SWITCHES ARE RATED BELOW 5A, A RELAY WILL BE REQUIRED.
- ENSURE THAT AN INLINE FUSE RATED TO 5 AMPS IS INSTALLED



**STEP 3.1** THE EASIEST LOCATION TO RUN THE POWER WIRE IS UP THE PASSENGER SIDE TRIM. PULL BACK THE REAR DOOR RUBBER GASKET AND TRIM PANELS AS SHOWN. BE CAREFUL WITH THE GREASE USED ON THE RUBBER GASKET.

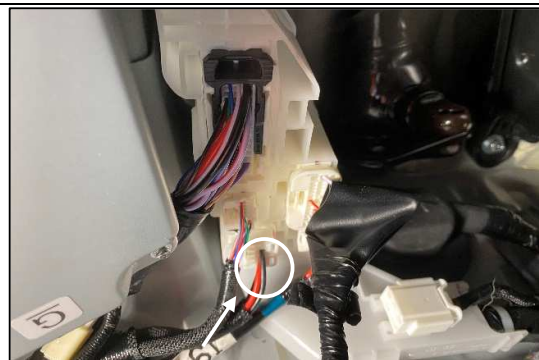

**STEP 3.2** A NEW POWER WIRE CAN BE RUN FROM EITHER THE START BATTERY OR A SECOND BATTERY (IF INSTALLED) DEPENDING ON PREFERENCE. A POWER WIRE IS AVAILABLE IN THE REAR PANEL NEAR THE JACK IF ABLE TO ACCESS THIS AREA (IF A DRAWER SYSTEM IS INSTALLED, THIS WILL BE DIFFICULT). UNPLUG THE LOOM SHOWN (BOTTOM LEFT) IF USING THIS POWER SOURCE.



**STEP 3.3** USE THE RED WIRE ON THE RIGHT WITH THE PLUG IN THE ORIENTATION SHOWN. TEST FOR CONSTANT POWER USING A 12V TEST LIGHT IF NOT SURE. TAP IN A 4MM WIRE (APPROX 2.5-3.0M LONG) ENSURING A 5A INLINE FUSE IS USED AND ABLE TO BE ACCESSED LATER IF REQUIRED.



**STEP 3.4** GENTLY PULL DOWN THE ROOF LINING AND RUN ALONG TO DOOR GROMMET. FEED THE WIRE THROUGH THE GROMMET AND INTO THE TAILGATE SECTION AS SHOWN. RUN POWER WIRE ALONG TOYOTA LOOM AND CABLE TIE NEATLY ALONG TO MEET LED LIGHT. THE LIGHT CAN BE EARTHED INTO THE TAILGATE DOOR. BE CAREFUL NOT TO USE A LOCATION WITH A PLASTIC GROMMET FOR THE SCREW.

## 3.1 ADDITIONAL STEPS REQUIRED ONLY IF FITTING OPTIONAL 19MM JBA SWITCH

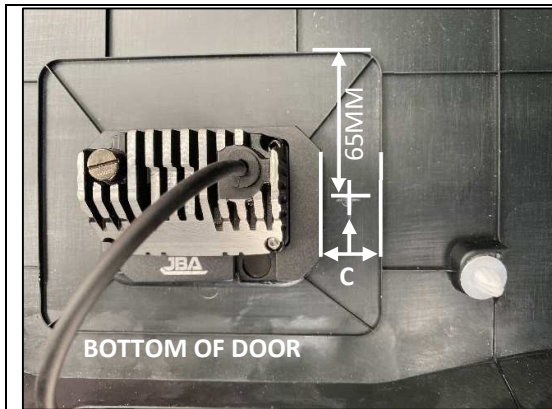

**STEP 3.1.1** THE SUGGESTED POSITION OF THE 19M SWITCH IS TO THE DRIVERS SIDE NEXT TO THE LIGHT. IF FITTING TO A VEHICLE WITH AUTO TAILGATE MECHANISM, IT WILL NOT FIT TO THE PASSENGER SIDE DUE TO INTERFERENCE WITH SURROUNDING PARTS. MARK THE LOCATION AS PER DIAGRAM SHOWN.



**STEP 3.1.2** DRILL THE SWITCH HOLE OUT TO 20MM USING STEP DRILL AS SHOWN. INSERT THE SWITCH AND TIGHTEN NUT FROM BEHIND.

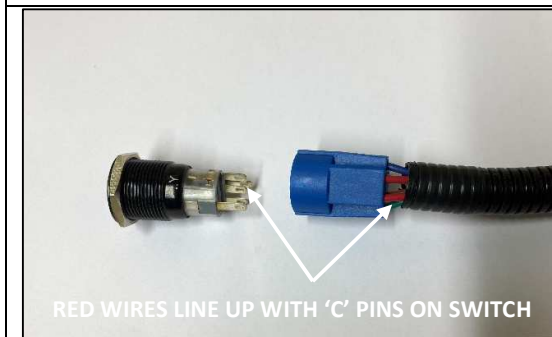

**STEP 3.1.3** IF FITTING 3 WAY SWITCH WITH JBA HARNESS, CONNECT THE SWITCH WITH THE 'C' PINS (LOCATED ON THE GREY FACE OF THE SWITCH AT THE BOTTOM OF THE PINS) INTO THE PINS WITH RED WIRES IN THE HARNESS.

**STEP 3.1.4** IF FITTING 19MM PUSH BUTTON SWITCH FOR 'WHITE ONLY' LED, FOLLOW THE BELOW WIRING DIAGRAM.

### WIRING DIAGRAM FOR 19MM PUSH BUTTON WHITE ONLY LED

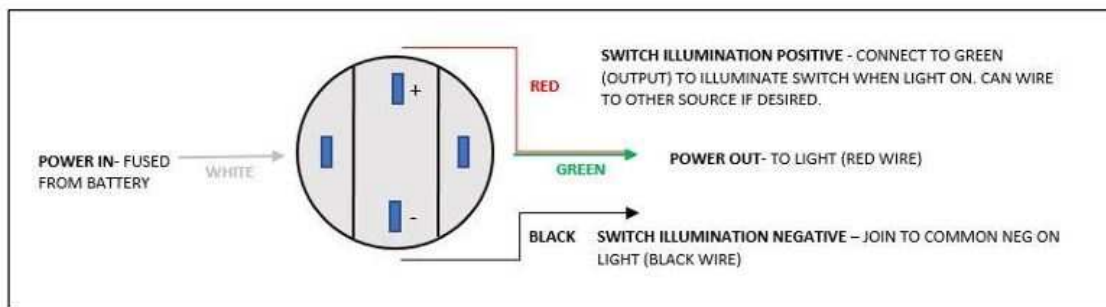

\* NOTE- BLUE WIRE NOT USED/CONNECTED



### 3.2 ADDITIONAL STEPS REQUIRED ONLY IF FITTING JBA 3 WAY SWITCH FOR DUAL AMBER/WHITE LED

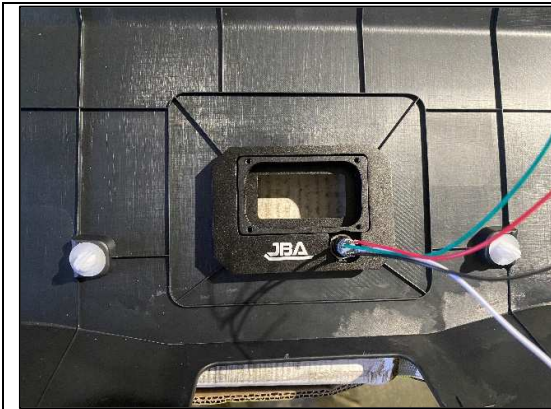

**STEP 3.2.1** CONNECT POWER WIRES PROVIDED WITH THE SWITCH AS SHOWN AND WIRE IN FOLLOWING THE DIAGRAM BELOW.

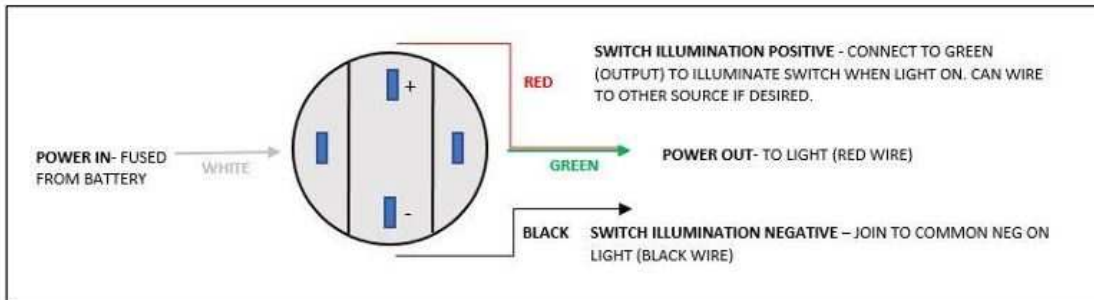

### 3.3 GENERIC WIRING DIAGRAMS FOR NON JBA OPTIONAL SWITCHES

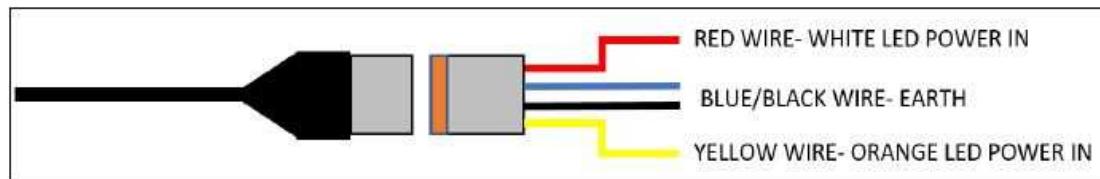
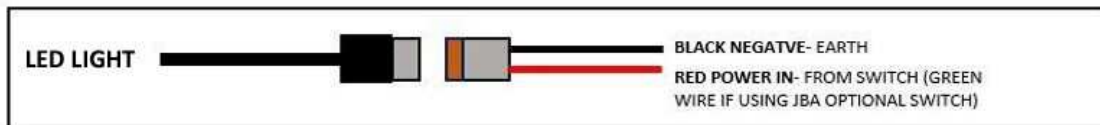

## 4. FINAL STEPS



**STEP 4.1** RE-INSTALL REAR TAILGATE PANELS AND PLUG LED LIGHT INTO WIRING INSTALLED IN STEPS 3.1 TO 3.3 ABOVE.



**STEP 4.2** TEST LED AND WIPE DOWN ALL PANELS.